

## Waveguide High Power Circulators

Part Number: KTWC320-25.4B1

### Key Features

- Broad Frequency Range: 26.4GHz-40.1GHz
- High Peak Power: 500W
- High Isolation, Low Insertion Loss, Small Size
- Wide Operating Temperature Range: -40°C~+85°C
- Commercial, Military and Space Applications

### Electrical Specifications at Room Temperature

Part Number	Freq. Range (GHz)	Relative Bandwidth	Insertion Loss Max. (dB)	Isolation Min. (dB)	VSWR Max.	Peak Power (W)	Duty Ratio	Waveguide Type
KTWC320-25.4B1	26.4 - 40.1	3%	0.3	20	1.20	500	10%	WR28

### Mechanical Dimensions (mm)

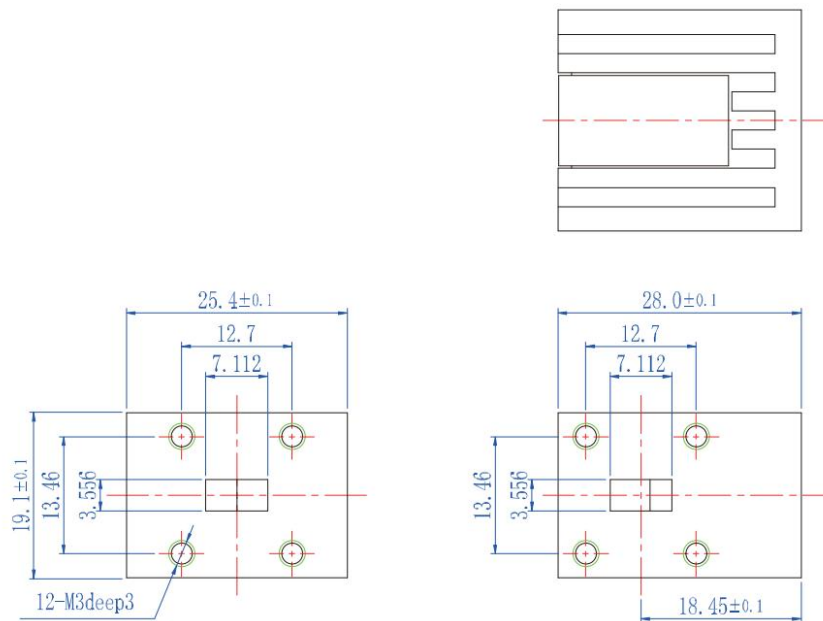

### HOW TO ORDER

